

ANTI-LIGATURE RANGE





Dortrend - specialists in door fittings

Established in the mid 70s Dortrend has developed into a respected innovator, manufacturer and designer of specialist door handles including fittings for the less physically able, antibacterial handles and anti-ligature fittings.

We are pleased to publish the fourth version of our anti-ligature catalogue detailing our wide range of products.

What makes us unique is that as we manufacture our products to very high standards and tight tolerances in our factory in the UK, we can adjust them to the specific needs of the clients and staff of mental health units.

Our experience in manufacturing and the experience of our customers combined has resulted in many of the products illustrated in this brochure. However, we never stop striving to achieve better products and we are always pleased to receive input from the people using our products and working with them to improve their performance or design new products to meet specific needs.

We fully recognise that door fittings function and staff safety issues will vary widely between establishments and we have produced a range of options to cover most eventualities.

A huge variety of designs have been produced and it would have been impossible to illustrate in this catalogue all the products we have developed for the mental health care market.

If you do not see what you require in this catalogue please contact our sales team and we will do our best to help you. We can offer all our products coated with TouchClean® antibacterial coating to protect staff and clients from bacteria spread by contact with door fittings. Another innovation from Dortrend.

Standard finishes

Satin Stainless Steel SSS
Polished and anodised aluminium AS

Special orders

TouchClean® antibacterial finish TC
Polished brass PB
Mirror polished stainless steel PSS
Easy grip crinkle coated EPCR
(for improved grip without assisting
ligatures)
Epoxy powder coated EP

Quality

All our products have been tested in accordance with DHF (Door and Hardware Federation) Technical Specifications for "Door Mounted Anti-ligature Devices for Safety and Security Purposes" (TF001). Our own in house tests also focus on the products ability to resist damage and maintain function if attacked. For details of DHF testing please see their website at www.abhm.org.uk. More information and short videos can be viewed on our website at www.dortrend.co.uk. We take every possible care to design our products to be ligature resistant, robust and visually attractive.

Dortrend International has been the innovator in door furniture design for many years and was amongst the first to develop products for the healthcare industry, as well as anti-ligature products, to protect vulnerable patients and residents of homes, institutions and hospitals.

Design copyright

All the door handles and accessories in this catalogue are original designs of, and manufactured by, Dortrend. The copyright in all designs belongs to Dortrend International Ltd.

Product range

The range of products we offer is not limited to those shown in this catalogue as there are too many variants and possibilities to show.

We have therefore included the most commonly used examples: if you do not see what you want here please contact us to discuss your requirements.

Latest products

Printed catalogues can get out of date due to the introduction of new ranges. We therefore advise customers to check our web site for the latest additions.

www.dortrend.co.uk

The web site shows details of the extensive range of other Dortrend products as well as those in this catalogue.



TouchClean® is an antibacterial and antiviral coating that protects against hand borne organisms such as MRSA, e-coli, SARS, c-diff, etc. It is self cleaning too. All Dortrend products can be supplied with this coating to special order.



dortrend
International Ltd.



contents	Page
lever handles & knobs	4 - 5
pull handles	6 - 8
clutch turns & escutcheons	9 - 10
window fittings	11
washroom fittings	12 - 13
door accessories	14 - 15



Photographs in this brochure with this icon have a video demonstration which can be viewed on our website at www.dortrend.co.uk

All dimensions, weights etc. given in this brochure are approximate.

Dortrend International Limited is continually refining and improving its product range, and therefore reserves the right to alter specification without prior notice, where this proves necessary for technical or other reasons.

Any items ordered from this brochure are subject to our standard terms and conditions of sale, which are printed in our current price list, a copy of which is available upon request.

Dortrend International Limited has taken maximum care designing these products. However the Company cannot guarantee that there are no circumstances in which self harm is not possible.

4 lever handles & knobs

ANTNS7SSS

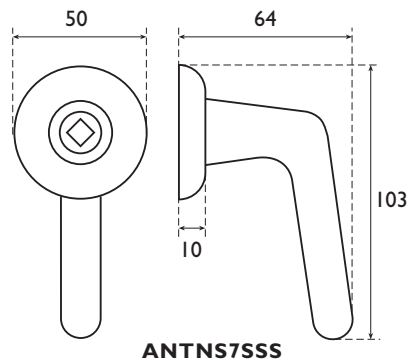

ANTNS7SSS

ANTNS7SSS anti-ligature lever set.

The lever handle is set at a 45 degree angle.

When pressure is applied it falls to 90 degrees (vertical) causing the ligature to slip off. The lever set bolts through the door at 38mm centres and on the client side of the door there are no visible fixings. Can be used in conjunction with a blind rose as a set and also on a plate to customers specifications. Available in aluminium, satin stainless steel or textured powder coated.

ANTI9 lever set.

A curved lever handle which features bolt through fixings at 38mm centres and has no visible fixings on the client side. The lever sits on the door at a 45 degree angle and falls to vertical when pressurised. This lever was developed to enable the less physically able to operate doors easily but is also a very strong handle offering excellent resistance to ligatures.

It is recommended that this product is used in conjunction with an inverted lock. Due to the lever handle clashing with a turn when used in conjunction with a cylinder or bathroom turn, we advise that this handle should be used with a heavily sprung DIN standard lock case. Can be used in conjunction with a blind rose as a set and also on a plate to customers specifications.

Available in aluminium or stainless steel and to any RAL number.

See this product in action on www.dortrend.co.uk

ANTI9



Our anti-ligature levers and knobs are designed to function with most proximity locks, and have been successfully employed on many major projects.

ANTNS763SSS



ANTNS763SSS

As ANTNS7SSS but on 63mm rose.

ANTNS7ESPAG



ANTNS7ESPAG

The solution for fitting levers to metal doors, manufactured to your requirements to suit most leading manufacturer's multi point locks.

Please contact our sales office for details.

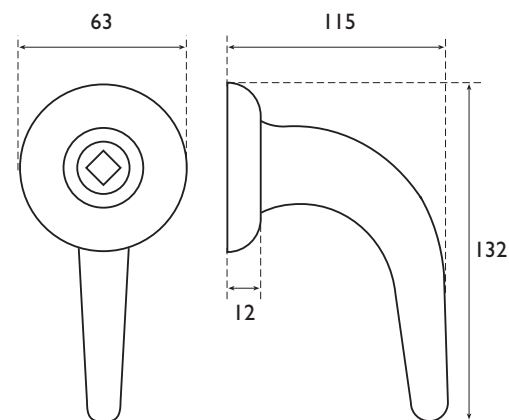

ANTI9



ANT19 kit

The combination illustrated shows the levers and turns on plates this combination has many advantages as it strengthens the door at its weakest point, ensures that the surface is perfectly flat for mounting the handles and can also aid fitting to doors when handles are being replaced. This arrangement ensures stability on the door designed for heavy use on thicker plates (5mm thick) handle roses are fitted to the plates and the plates are bolted through the doors.



ANT7OBR/OBRO



ANT7OBR/OBRO

ANT7 lever on oblong rose complete with oblong rose bolt through door for added security for use on metal doors supplied as a complete set.

ANT22CLSWSSS



ANT22CLSWSSS

This product combines the anti-ligature proofing of a knob with the convenience and ease of use of a lever handle. It also is clutched therefore combining all the requirements needed for total peace of mind.

Available in stainless steel only.

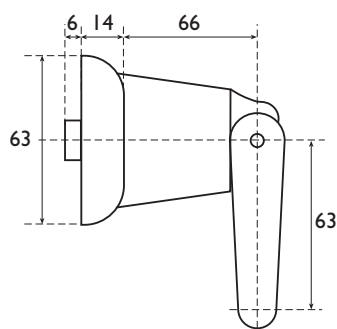

ANT22CLSWSSS

ANTI

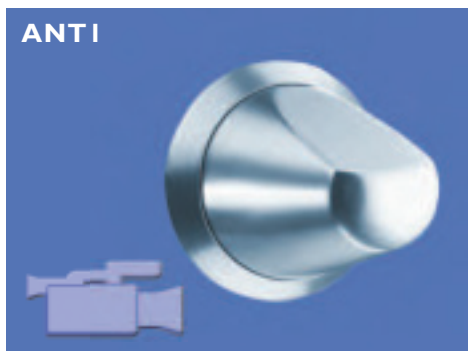

ANTI

An anti-ligature knob, which can be grooved if required, chamfered to allow maximum grip and ligature resistance. Can be used in conjunction with a blind rose as a set and also on a plate to customer's specifications. Available in polished aluminium, satin stainless steel and crinkle powder coated finish.

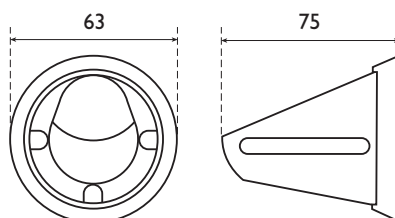

ANTI

ANT6

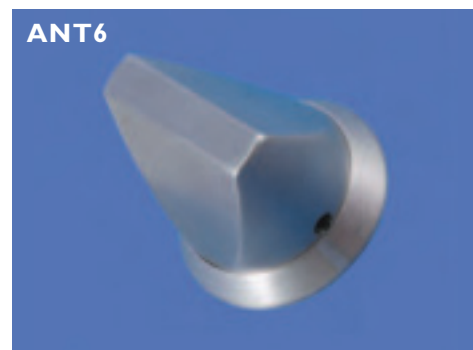

ANT6

An anti-ligature knob set with double chamfer which can be used in conjunction with anti-ligature lever handle in knob/lever combination. It can be bolted through a door for a concealed fixing at 38mm centres and can also be used in conjunction with a blind rose as a set or on a plate to customer's specifications. Available in polished aluminium, stainless steel, crinkle powder coated finish and powder coated to any RAL number.

We can provide plates made to any size bolted through to ferrules or face fixed.

We can supply kicking plates that have ultra softened edges raduised edges and are fixed with anti tamper screws.

ANT2PL**ANT2PL**

Pull handle 25mm diameter x 150mm length on a 265 x 75mm plate (plate can be changed to customers specification) available in polished aluminium or satin stainless steel.

Options

Face fix pull handle on plate ANT2PL

Back to back pull handle on plate ANT2BBPL

Pull handle on plate fixed back to back with finger plate ANT2BTP

Pull handle on rose ANT2RR

ANT5PL**ANT5PL**

32 x 150mm pull handle on 190 x 65mm plate (plate can be made to customers specification) available in polished aluminium or satin stainless steel.

Options

Back to back on plate ANT5PLBB

Face fix on plate ANT5PL

Back to back with finger plate ANT5BTPL

ANTWHISS**ANTWHISS**

ANTWHISS manufactured from stainless steel available in the following variations

ANTWHISSBT bolt through

ANTWHISSBB back to back fixing.

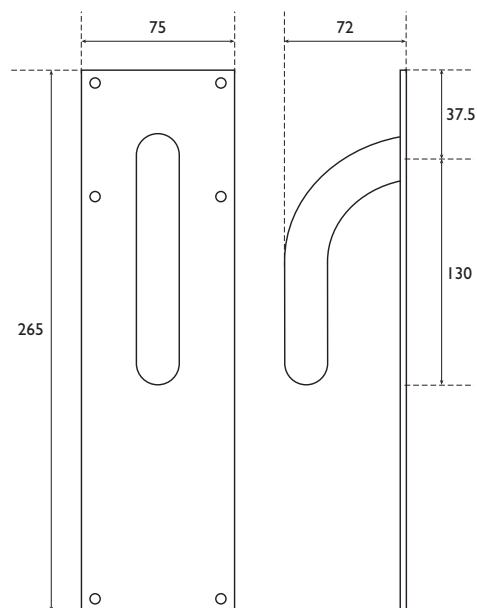
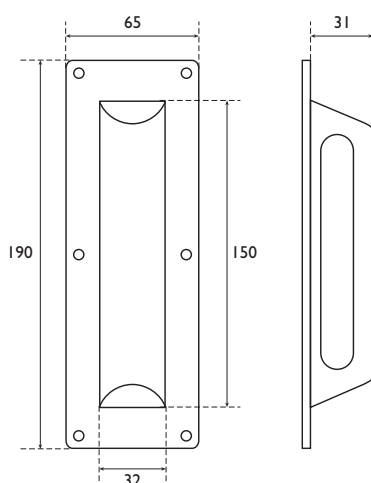
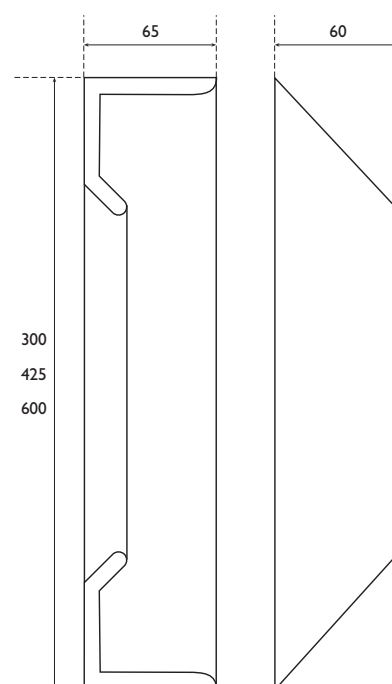
**ANT2PL****ANT5PL****ANTWHISS**

ANTWHI



ANT25INFILLPL



ANT25INFILLPL

An anti-ligature infill pull handle on plate 25dia x 225mm on 300 x 75mm plate
Available in polished aluminium or satin stainless steel

Alternative sizes available to special order.
Infill plate prevents the introduction of ligatures.

Large diameter pull handle gives sufficient grip to pull door closed.

Options

Face fix on plate ANT25INFILLPLFF

Back to back on plate ANT25INFILLBB.

ANTWHI

An aluminium pad handle designed to deter the attachment of ligatures by being angled top and bottom standard size is 300mm x 65mm.

Length can be varied to customer's requirements.

Options

ANTWHIASBT bolt through

ANTWHIASBB back to back fixed.

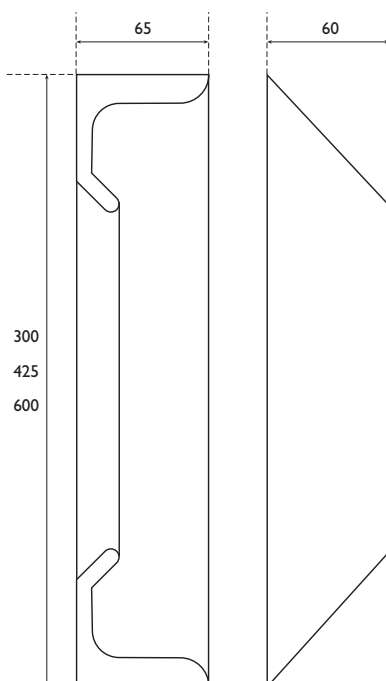

ANTWHI

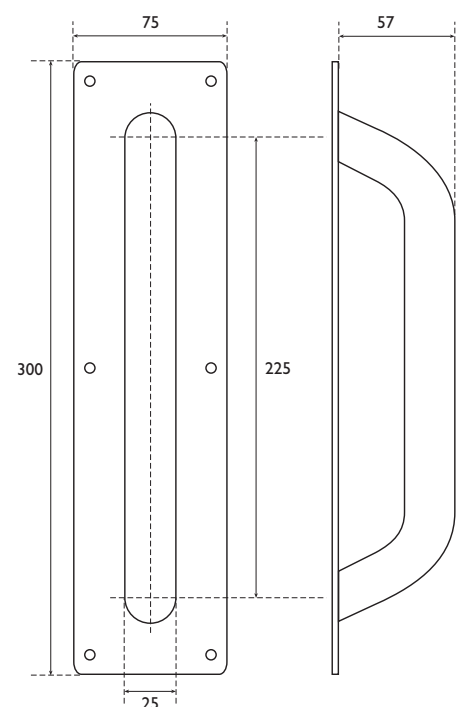

ANTINFILLPL

ANTFPI**ANTFPI**

A Flush pull handle 150 x 105mm. This pull handle has passed relevant fire tests using Lorient products intumescent pads (not supplied) for full details please contact our sales office. The inside of the grip is curved to prevent the insertion of a part to attach a ligature. there is an excellent grip and it can be fitted vertically or horizontally. Available in face fix or back to back supplied complete with tamperproof fixings.

Options

Single face fix ANTFPI

A pair back to back fix ANTFPIBB.

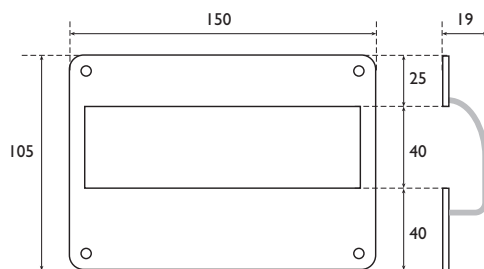
**ANTFPI****ANTNORTONPL**

An anti-ligature pull handle with smooth lines which discourage attachment of ligatures whilst having a “non institutional” appearance.

Available in polished aluminium, satin stainless steel.

ANTFP2**ANTFP2**

A flush pull handle 170 x 150mm. This pull handle has passed relevant fire tests using Lorient products intumescent pads (not supplied, please contact our sales office for details). The inside of the grip is curved to prevent the insertion of a part to attach a ligature. there is an excellent grip and it can be fitted vertically or horizontally. Available in face fix or back to back supplied complete with tamperproof fixings.

Options

Single face fix ANTFP2

A pair back to back fix ANTFP2BB.

Contact our sales office for advice on back to back fixing Flush Pulls.

We recommend that these products are used in conjunction with intumescent pads.

ANTNORTONPL**ANT55****ANT55**

Pull handle with larger grip than ANT5 available in stainless steel and aluminium. Powder coated to special order.

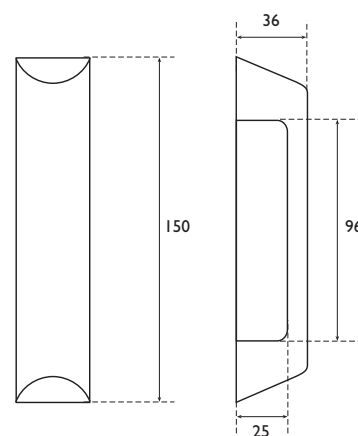
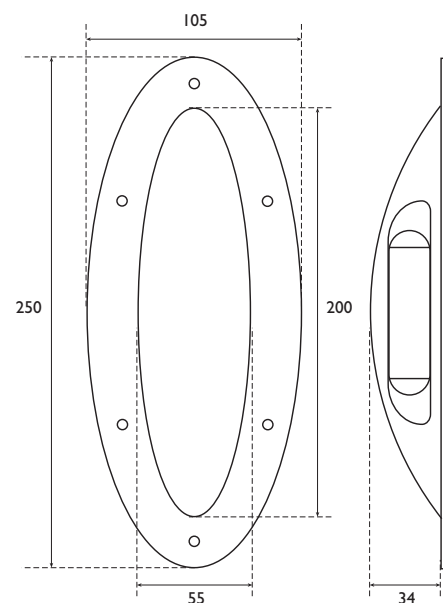
**ANT55****ANTORTONPL**

ANT363TT

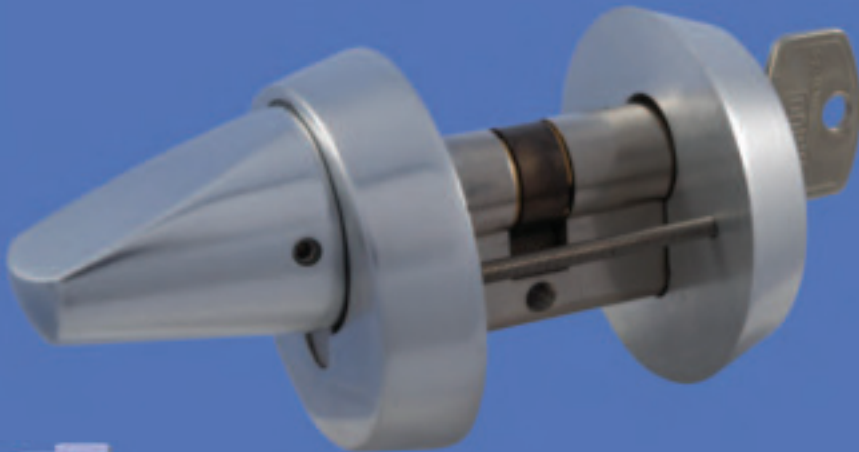

ANT363TT

The Dortrend anti-ligature clutch knob can be fitted to most cylinders, converting the cylinder to a anti-barricading solution.

Most of the levers and knobs in this catalogue can be clutched, addressing a major concern in care homes in an efficient and economical way.

Please state door thickness cylinder length and whether the cylinder is equal or unequal.

Can be fitted to a cylinder or bathroom turn.

ANT364TT



ANT364TT

An easy grip anti ligature knob can be used to pull the door closed available in stainless steel and aluminium. Can also be used in conjunction with bathroom set.

ANTTPIFMI

Release key *

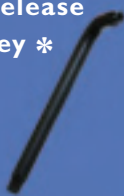

ANTTPIFMI

Anti-ligature torx pin release anti-tamper bathroom indicator release can be used in conjunction with the turns illustrated with or without clutch knob mechanism red /white indicator.



ANTIFMI2CLTCK



ANTLOK

ANTIFMI2CLTCK

A clutched bathroom turn to prevent barricading with a carriage key release, we can supply coin release or torx pin release to special order.

ANTIFMI2

Key included

8mm spindle

63mm roses

Spare key for the release in stainless steel ANTLK.

ANTLOK

Carriage key release key in stainless steel.

* Spare key for torx pin release

ANTLKT

10 clutch turns & escutcheons

ANTATIFMI2CL



ANTATIFMI2CL

A bathroom set with clutch knob to prevent barricading.

Key Release included.

Coin release to special order.

ANTATIFMI2

A bathroom set with key Release included. Spindle size 8mm.

Spare key for the release in stainless steel ANTLOK.

ANT363



ANT363

A 63 x 10mm escutcheon with chamfered edge which eliminates use as a ligature point.

Available in aluminium or satin stainless steel. Supplied with tamperproof screws.

Options

Face fixed ANT363FF

Back to back ANT363BB

Back to back with blank ANT363BBBL

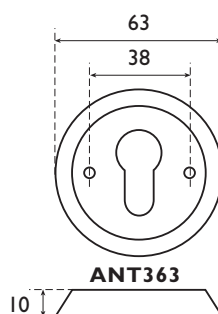

ANT350



ANT350

A 50 x 10mm euro escutcheon with chamfered edges which eliminates use as a ligature point.

Available in aluminium or stainless steel.

Options

Face fix ANT350FF

Back to back ANT350BB

Back to back with blank ANT350BBBL

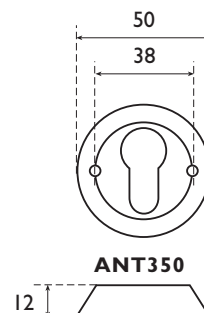

ANTELESC



ANTELESC

Anti-ligature locking escutcheon for use in areas where cylinders can be jammed by pushing foreign objects into them.

ANT363B

Blank escutcheon 63 x 10mm with chamfered edges to eliminate use as a ligature point.

Options

Face fix ANT363BFF

Back fix ANT363BBF

Back to back ANT363BLBB

ANT363B



Shims for ensuring cylinders are flush with top of escutcheons (not illustrated)

50mm x 1mm	50mm x 1.5mm	50mm x 2mm	50mm x 3mm
63mm x 1mm	50mm x 1.5mm	50mm x 2mm	50mm x 3mm

ANTPH2



ANTPH2

A simple window pull handle 150mm long by 34mm wide with chamfered sides to prevent ligature attachment. Available in aluminium or crinkle powder coated finish.

ANTWIN2



ANTWIN2

A handle for use with espagnolette windows. Handle is removable and can be kept on a keyring, ideal for top hung windows.

Available in satin stainless steel only.

ANTWIN4



ANTWIN4

A locking handle for use with espagnolette windows. The handle is set on a ball joint and swings freely on release, available in satin stainless steel only.

ANTWIN6



ANTWIN6

A window pull with key hole length 150mm long x 22mm wide. Key to supplied to operate espagnolette. Available in aluminium or crinkle powder coated finish.

ANTWIN52



ANTWIN52

A 100mm long x 22mm wide slim line window pull handle. Available in aluminium and crinkle powder coated finish. Can be supplied on a plate for face fixing.

Release
key



ANTWCSPAS



ANTWCSPAS

Cockspur anti-ligature window fastener. Designed to prevent unauthorised opening of windows. Torx pin key release. Cockspur can be locked back out of sight when window is open.

ANTWINCUP



ANTWINCUP

Anti ligature cup type pull handle for use on espagnolette windows complete with key. Can be fitted to top or side hung.

ANTWIN88SSS



ANTWIN88SSS

Window pull with 35mm lockable turn spindle 7mm to operate espagnolette window locking system.

ANTWIN288SSS



ANTWIN288SSS

Window pull with swivel lever lockable spindle 7mm to operate espagnolette window locking system.

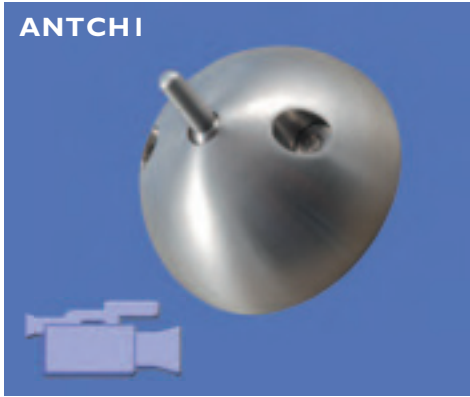
ANTCHI**ANTCHI**

An anti-ligature coat hook 63mm diameter. The "hook" is fixed in a ball joint held in place by a spring loaded ball bearing. It will take the weight of a normal coat but additional weight will cause it to collapse, releasing any ligature. Available in stainless steel and aluminium. Can be adjusted for differing weight requirements this adjustment is not accessible once the hook is fitted with its tamperproof fixings. Can also be supplied four to a plate.

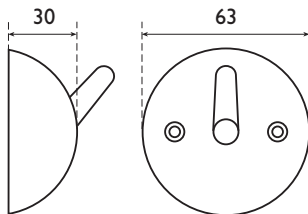
**ANTCHI****ANTSUPPC****ANTSUPPC**

Floor mounted support for side of w.c.

ANTPCSRW**ANTPCSRW locking detail****ANTPCSRW****Anti-ligature Support Arm**

This arm can be safely locked down to discourage the attachment of ligatures. For use with Dortrend grab rails to give a safe solution.

Available in white and blue other colours to special order coated with our TouchClean® antibacterial finish.

ANT22EPC**ANT22EPC****Vertical grab rail**

Fixed vertically this grab rail can be used in conjunction with our support and horizontal grab rails available in white or blue (illustrated) other colours to special order. Coated in our TouchClean® antibacterial finish, for full details visit our web site.

ANTHRSEPC**ANTHRSEPC**

Dortrend anti-ligature handrail system designed to deter ligature attachment and concealing of items behind the area being gripped.

Made to order to length required.

Also available anti-ligature shelf (not illustrated) in SSS, PSS, AS and colour coated.

ANTSREPC**ANTSREPC**

Shower rail can be fixed vertically or horizontally fillet plate angled to facilitate drainage of shower water coated with TouchClean® antibacterial finish for full details visit our web site.

ANTDV2 (not illustrated)

Coach key operated door viewer with 180° field of vision. Unique action ensures client privacy.

ANTGRPC**ANTGRPC**

Grab rail infill handle support provided by holding tubular pull handle or placing arm onto length of handle this product can be customised to specific requirements. Available in white or blue (illustrated) other colours to special order. Standard length is 600mm. Coated with our TouchClean® antibacterial finish.

ANTSPHSSS**ANTSPHSSS**

Anti-ligature soap holder for bath or shower in satin stainless steel 160mm high by 210 wide.

Can be fixed with security screws or bonded into the wall.

ANTTRH**ANTTRH**

Anti-ligature toilet roll holder.

Dimensions 210mm x 210mm.

Can be fixed with security screws or bonded into the wall.

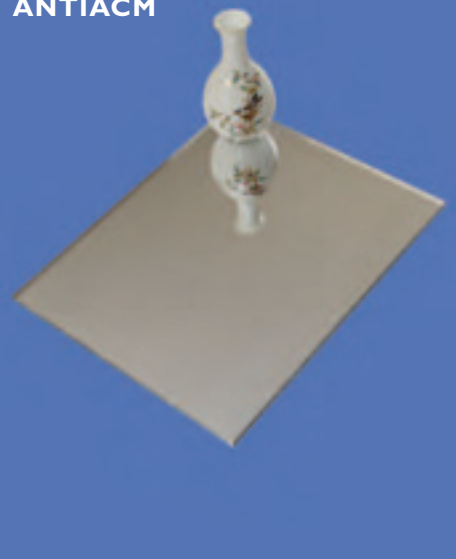
ANTIACM**ANTIACM**

Polycarbonate mirror unbreakable 3mm thick 450 x 275mm other sizes to special order supplied with torx pin security screws. Complete safety where glass or metal could compromise the safety of staff and clients.

ANTHBDSSSS**ANTHBDSSSS**

For use with pivots below.

Hold back door stop.

To activate as a stop - press central pin in.

To allow the door to swing outwards - push in whole stop.

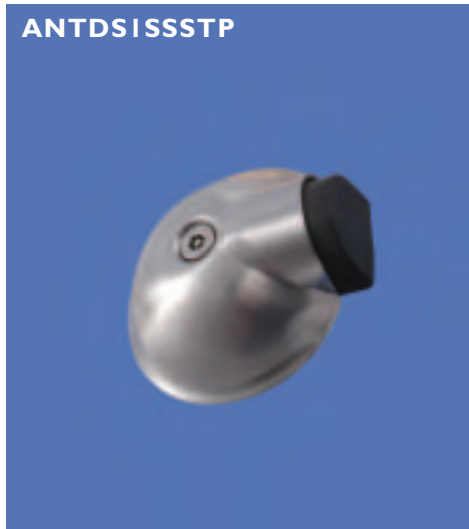
ANTDSISSSTP**ANTDSISSSTP**

Floor door stop supplied complete with tamperproof screw.

Also available (not illustrated) removable door stop with unique quick release key action which releases the stop in one movement.

ANTERDS**ANTERDS**

Emergency release door stop designed for use with a pivot set (below).

When the release device is pushed in the door can be opened outwards as well normal inward opening.

ANTPIVS**ANTPIVS**

Double action pivot set.

A good solution to barricading issues when used with ANTHBDSSS or ANTERDS.

ANTPPSSS**ANTPPSSS**

Pivot point protector (please state door thickness when ordering).

This product protects double swing doors from damage caused by them being forced over the door stop. It is also an economical way of repairing damaged doors, extending the door life at a economical cost.

All Dortrend anti-ligature products are supplied with the appropriate security fasteners (left).

Please note :

we do not recommend the use of power drivers when installing these fixings.

**ANTCONCDC****ANTCONCDC**

Door Closer. When mounted near the bottom of the door, this door closer is a ligature resistant solution where a door closer is required.



ANTWREPC

ANTWREPC

Dortrend anti-ligature wardrobe rail.

Designed to discourage the attachment of ligatures for use with Dortrend ANTLIGH hangers (see right) or other proprietary coat hangers.

This system is superior to magnetic systems where the rail can be removed and used to endanger staff or for self harm.

Can be supplied in a range of colours please state RAL number when ordering or contact our sales office for options available.



ANTLIGH

ANTLIGH

The hanger is designed to fail if excessive weight is exerted and is designed to discourage the combining of a number of hangers to form a ligature point.



ANTLIGH



ANTHGSSS

ANTHGSSS

An anti-ligature class 13 ball race hinge in stainless steel 100 x 75mm.

ANTCHGSSS

Anti-ligature continuous hinges provide an even weight distribution and uninterrupted sight line down the entire length of the door, which greatly reduces the possibility of a ligature point.

The hinge has been tested to BS EN 1935 Grade 14, CE marked and suitable for use on 30 and 60 minute fire doors.

The range is available in a choice of widths and in standard lengths of 2000mm and 2134mm, with the option of non standard lengths to order.

Available in a range of standard finishes.



ANTCHGSSS





dortrend

International Ltd.

Dortrend International Ltd.

Riverside Business Centre
Worcester Road
Stourport-on-Severn
Worcestershire DY13 9BZ

Tel: 01299 827837
Fax: 01299 827094

e-mail: sales@dortrend.co.uk
website: www.dortrend.co.uk

